

United States Department of the Interior
National Park Service

National Register of Historic Places
Inventory—Nomination Form



Continuation sheet

Item number

Page

Name: Historic: West End Elementary School Location: Corner of Floyd Baker Blvd. and Broad St.

Common: Cherokee High School Classification: Building

Owner: Cherokee County School District #1
Box 460
Gaffney, S. C. 29342

Representation in Existing Surveys: South Carolina Inventory of Historic Places, 1985

Description: The West End Elementary School is a large, two-story, brick building on a raised brick basement. Brick is stretcher bond. The facade (southeast elevation) is divided into thirteen bays; the section containing the three central bays is recessed and contains the main entrance. This entrance features a crenellated surround with a Tudor arch and large finials. Recessed behind the entrance are double doors with a transom. The building has twenty-four-light metal casement windows, which are paired in the central recessed section of the facade. Windows on the first story of the facade have label moldings; those on the second story are topped by lintels. A water table defines the top of the basement level; belt courses define the bottom of the first and second story windows. At the roofline of the building is a crenellated parapet; inset into the parapet on the facade and on the side (southwest and northeast) elevations are concrete panels with shield designs inscribed with words such as "Thrift," "Industry," "Charity," and "Hope." A larger panel, located over the main entrance, is inscribed with "Pro Patria." Modern additions have been constructed on the rear (northwest elevation) of the school.

Significance: The West End Elementary School is significant for its association with the history of public education in the city of Gaffney and for its local architectural distinction. The building, which was completed in 1917, served as a public elementary school from 1917-1975. In 1977, it became Cherokee High School. Today it is the oldest remaining intact public school building in the city. Victor I. Spurgeon, a prominent local contractor and builder, constructed the school. Among other buildings in Gaffney erected by Spurgeon were the Carnegie Library, the Cherokee Avenue School, the Ledger Building, and the C.E. Robbins (armory) Building. (71)

Acreage: Approximately 3.1 acres

Verbal Boundary Description: The boundary of the West End Elementary School nomination is shown as the dark line on the accompanying Cherokee County tax map 81-14, which is drawn at a scale of 1"=100'. The nominated property includes the school and the lot on which it is situated.

DTM Reference Point: 17/440420/3881780

Other Information:

Level of Significance: Local

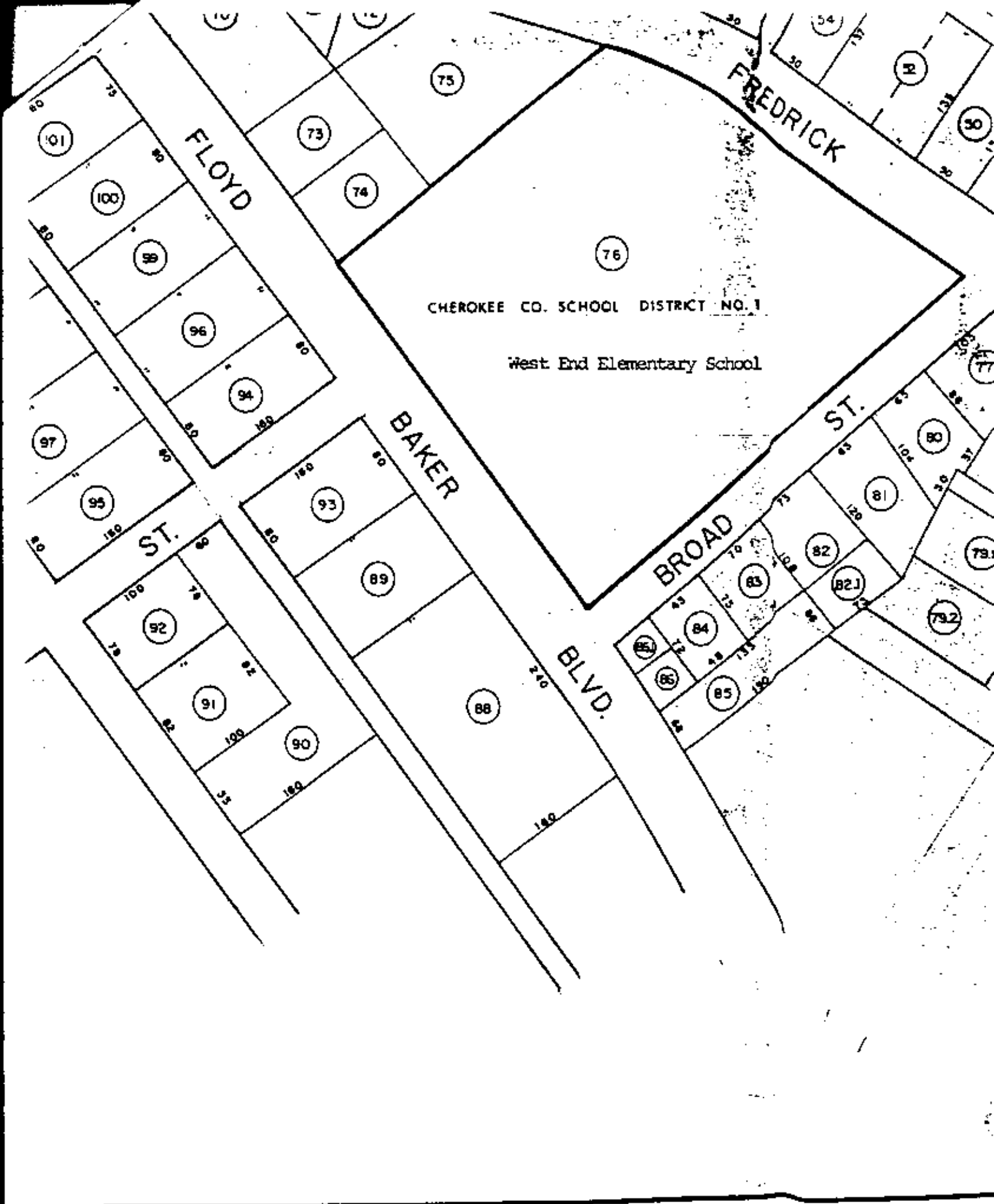

CHEROKEE CO. SCHOOL DISTRICT NO. 1

West End Elementary School

123 MAP PARCEL NUMBER
ORIGINAL LOT

PROPERTY MAP AND RECORDS SYSTEM