

UNITED STATES DEPARTMENT OF THE INTERIOR
NATIONAL PARK SERVICE

FOR NPS USE ONLY
RECEIVED
DATE ENTERED

NATIONAL REGISTER OF HISTORIC PLACES
INVENTORY -- NOMINATION FORM

SEE INSTRUCTIONS IN HOW TO COMPLETE NATIONAL REGISTER FORMS
TYPE ALL ENTRIES -- COMPLETE APPLICABLE SECTIONS

1 NAME

HISTORIC

Williams Graded School (preferred)

AND/OR COMMON

Old Lincolnville Town Hall

2 LOCATION

STREET & NUMBER

Pinckney Street

NOT FOR PUBLICATION

CITY, TOWN

Lincolnville

CONGRESSIONAL DISTRICT

First

STATE

South Carolina

VICINITY OF

CODE
045

COUNTY

Charleston

CODE

019

3 CLASSIFICATION

CATEGORY

- DISTRICT
- BUILDING(S)
- STRUCTURE
- SITE
- OBJECT

OWNERSHIP

- PUBLIC
- PRIVATE
- BOTH
- PUBLIC ACQUISITION**
- IN PROCESS
- BEING CONSIDERED

STATUS

- OCCUPIED
- UNOCCUPIED
- WORK IN PROGRESS
- ACCESSIBLE**
- YES: RESTRICTED
- YES: UNRESTRICTED
- NO

PRESENT USE

- AGRICULTURE
- COMMERICAL
- EDUCATIONAL
- ENTERTAINMENT
- GOVERNMENT
- INDUSTRIAL
- MILITARY
- MUSEUM
- PARK
- PRIVATE RESIDENCE
- RELIGIOUS
- SCIENTIFIC
- TRANSPORTATION
- OTHER:

4 OWNER OF PROPERTY

NAME

Town of Lincolnville

STREET & NUMBER

Broad Street

CITY, TOWN

Lincolnville

STATE

South Carolina 29483

VICINITY OF

5 LOCATION OF LEGAL DESCRIPTION

COURTHOUSE,
REGISTRY OF DEEDS, ETC.

Berkeley County Courthouse

STREET & NUMBER

CITY, TOWN

Moncks Corner

STATE

South Carolina 29461

6 REPRESENTATION IN EXISTING SURVEYS

TITLE

Inventory of Historic Places in South Carolina

DATE

1980 (update)

FEDERAL STATE COUNTY LOCAL

DEPOSITORY FOR
SURVEY RECORDS

South Carolina Department of Archives and History

CITY, TOWN

Columbia

STATE

South Carolina 29211

7 DESCRIPTION

CONDITION

EXCELLENT
 GOOD
 FAIR

DETERIORATED
 RUINS
 UNEXPOSED

CHECK ONE

UNALTERED
 ALTERED

CHECK ONE

ORIGINAL SITE
 MOVED DATE _____

DESCRIBE THE PRESENT AND ORIGINAL (IF KNOWN) PHYSICAL APPEARANCE

Located within the town limits of Lincolville, South Carolina, Williams Graded School was built in 1899. It is believed to have served as a combination school and town hall for the citizens of this black town, which was settled by freedmen after the Civil War.

Exterior: Rectangular in plan, the single story frame building with weatherboard siding is set on low brick piers, and metal roofing covers the gable roof. Brickwork on the piers is American common bond. The roof line of the facade (southeast elevation) and of the northeast and southwest elevations is framed by a boxed cornice with return. Except for the window in the gable end of the facade, all windows are 6 over 6 and feature the original batten shutters.

The facade is divided into three bays and has a central bay porch with a shed roof, with exposed rafters and plain square posts. The original wooden steps and floor of the porch have been replaced with concrete blocks. The porch shelters a double-leaf, paneled door and is flanked on the right and left by windows. Contained in the gable end is a small window with the original louvered shutters. A cornerstone set into the northeast pier is inscribed,

WILLIAMS GRADED SCHOOL
ERECTED FEB. 3, 1899
LINCOLNVILLE, S.C.

The northeast elevation has an exterior chimney near the center flanked on each side by two windows. Brickwork on the chimney is stretcher bond. A small masonry addition has been constructed at the extreme right end of the original portion of this elevation. Attached to the northwest elevation is a frame addition with a metal shed roof which extends the width of the building. The southwest elevation contains five bays with a door in the westernmost bay and a window in each of the other four bays.

Interior: The original portion of the building contains one large room. The northwest end of the room has a podium on a dais which is approached by three steps on the front and sides.

Alterations have been minimal, and the auditorium retains much of its original fabric, including wide board paneling beaded to simulate narrow boards on all four walls and the ceiling. The floor of the dais is also original. The two room rear addition constructed after 1899 provides space for a kitchen and an office. The masonry addition attached to the northeast elevation houses a bathroom.

Surroundings: Although it is within the town limits of Lincolville, the setting of Williams Graded School suggests a rural area. The front of the lot is bounded by a paved road; the adjoining lots on the sides and rear of the building are vacant and wooded.

8 SIGNIFICANCE

PERIOD	AREAS OF SIGNIFICANCE -- CHECK AND JUSTIFY BELOW			
<input type="checkbox"/> PREHISTORIC	<input type="checkbox"/> ARCHEOLOGY-PREHISTORIC	<input type="checkbox"/> COMMUNITY PLANNING	<input type="checkbox"/> LANDSCAPE ARCHITECTURE	<input type="checkbox"/> RELIGION
<input type="checkbox"/> 1400-1499	<input type="checkbox"/> ARCHEOLOGY-HISTORIC	<input type="checkbox"/> CONSERVATION	<input type="checkbox"/> LAW	<input type="checkbox"/> SCIENCE
<input type="checkbox"/> 1500-1599	<input type="checkbox"/> AGRICULTURE	<input type="checkbox"/> ECONOMICS	<input type="checkbox"/> LITERATURE	<input type="checkbox"/> SCULPTURE
<input type="checkbox"/> 1600-1899	<input type="checkbox"/> ARCHITECTURE	<input checked="" type="checkbox"/> EDUCATION	<input type="checkbox"/> MILITARY	<input type="checkbox"/> SOCIAL/HUMANITARIAN
<input type="checkbox"/> 1700-1799	<input type="checkbox"/> ART	<input type="checkbox"/> ENGINEERING	<input type="checkbox"/> MUSIC	<input type="checkbox"/> THEATER
<input checked="" type="checkbox"/> 1800-1899	<input type="checkbox"/> COMMERCE	<input type="checkbox"/> EXPLORATION/SETTLEMENT	<input type="checkbox"/> PHILOSOPHY	<input type="checkbox"/> TRANSPORTATION
<input checked="" type="checkbox"/> 1900-	<input type="checkbox"/> COMMUNICATIONS	<input type="checkbox"/> INDUSTRY	<input checked="" type="checkbox"/> POLITICS/GOVERNMENT	<input checked="" type="checkbox"/> OTHER (SPECIFY) Black History
		<input type="checkbox"/> INVENTION		

SPECIFIC DATES 1899

BUILDER/ARCHITECT

STATEMENT OF SIGNIFICANCE

Williams Graded School, located within the town limits of Lincolville, South Carolina, was constructed in 1899 and is believed to have served as a combination school and town hall. It is significant for its association with the citizens of a town populated by blacks that was established in the second half of the nineteenth century by a black man who was prominent in the political and religious life of the state during the era of Reconstruction. In addition, Williams Graded School is one of the few known surviving examples of public buildings associated with the history of blacks in late nineteenth- and early twentieth-century South Carolina which has remained basically unaltered.

Richard Harvey Cain, a prominent political and religious leader among the black population of the Charleston area, ca. 1871 contracted to buy 2000 acres about ten miles from Charleston. A leading proponent of obtaining land for freedmen since the Constitutional Convention of 1868, Cain divided the land into small lots which contained two to ten acres each, which he sold to freedmen. He named this settlement Lincolville. Cain was minister of Emmanuel African Methodist Church in Charleston, state senator from Charleston County between 1868 and 1870, and later a representative from South Carolina to the United States Congress.

In 1875 or 1876 Cain sold a lot on Pinckney Street in Lincolville, the present site of Williams Graded School, to Susan Owens for twenty-five dollars. The town of Lincolville was incorporated by the South Carolina General Assembly in 1889, and regulations for the government of the town were enacted. The statute stated that the town would be governed by a town council consisting of an intendant and four wardens. In 1899 Susan Owens sold her lot to A.T. Williams, an intendant of Lincolville around the turn of the century. The cornerstone of the building indicates that Williams Graded School was constructed in that same year. Between 1899 and 1902 Williams agreed to sell the property to the town of Lincolville. The final payment was not made and the title conveyed to the town until 1906. However, extant records, including the cornerstone, indicate that the building was used earlier by the town as a school. According to local tradition, the building also served as a town hall each day after school was dismissed. After a new school was built in 1924, the building was used solely as a town hall until 1959 or 1960, when a new town hall was constructed. Although the building is still owned by the town of Lincolville, it is presently used as a church by the Friendship Church of God and Christ.

9 MAJOR BIBLIOGRAPHICAL REFERENCES

Acts and Joint Resolutions of the General Assembly of the State of South Carolina, Passed at the Regular Session of 1889. Columbia, S.C.: James H. Woodrow, 1890, pp. 468-72.

Biographical Directory of the American Congress, 1774-1961. Washington, D.C.: Government Printing Office, 1961, p. 646.

10 GEOGRAPHICAL DATA

ACREAGE OF NOMINATED PROPERTY 1.0

UTM REFERENCES

A	1,7	5,7,9,1,0,0	3,6,5,2,6,0,0	B			
	ZONE	EASTING	NORTHING		ZONE	EASTING	NORTHING
C				D			

VERBAL BOUNDARY DESCRIPTION

The boundary of the Williams Graded School nomination is shown as the red line on the accompanying map entitled "Tax Map Number 385-1-0, Charleston County, S.C." and drawn at a scale of 1" = 100'.

LIST ALL STATES AND COUNTIES FOR PROPERTIES OVERLAPPING STATE OR COUNTY BOUNDARIES

STATE	CODE	COUNTY	CODE
STATE	CODE	COUNTY	CODE

11 FORM PREPARED BY

NAME / TITLE
Mary Watson, Historic Preservation Division

David Chamberlain, Elias Bull
Berkeley-Charleston-Dorchester
Council of Governments

ORGANIZATION
South Carolina Department of Archives and History

DATE
May 21, 1980

STREET & NUMBER
Box 11,669, Capitol Station

TELEPHONE
803-758-5816

CITY OR TOWN
Columbia

STATE
South Carolina 29211

12 STATE HISTORIC PRESERVATION OFFICER CERTIFICATION

THE EVALUATED SIGNIFICANCE OF THIS PROPERTY WITHIN THE STATE IS:

NATIONAL STATE LOCAL X

As the designated State Historic Preservation Officer for the National Historic Preservation Act of 1966 (Public Law 89-665), I hereby nominate this property for inclusion in the National Register and certify that it has been evaluated according to the criteria and procedures set forth by the National Park Service.

STATE HISTORIC PRESERVATION OFFICER SIGNATURE

Charles L. ...

DATE

TITLE

SCPHO

June 2, 1980

FOR NPS USE ONLY

I HEREBY CERTIFY THAT THIS PROPERTY IS INCLUDED IN THE NATIONAL REGISTER

DATE

DIRECTOR, OFFICE OF ARCHEOLOGY AND HISTORIC PRESERVATION

ATTEST:

DATE

KEEPER OF THE NATIONAL REGISTER

**United States Department of the Interior
Heritage Conservation and Recreation Service**

**National Register of Historic Places
Inventory—Nomination Form**

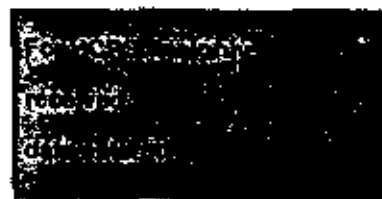

Continuation sheet

Item number 9

Page 1

- Bleser, Carol K. Rothrock. The Promised Land: The History of the South Carolina Land Commission, 1869-1890. Columbia: University of South Carolina Press, 1969, pp. 19, 20, 28, 76, 77.
- "Inferior Court." The Charleston Daily News, 14 January 1873, p. 4.
- Johnson, Allen, ed. Dictionary of American Biography. Vol. 3. New York: Charles Scribner's Son's, 1929, pp. 403-404.
- Ordinance passed on 23 June 1902 by the intendant and wardens of the town of Lincolville. Lincolville Town Hall, Broad Street, Lincolville, S.C.
- Records of Mesne Conveyance. Deed Book A15, p. 238; Deed Book C10, pp. 259-261. Berkeley County Clerk of Court, Moncks Corner, S.C.
- Records of Mesne Conveyance. Deed Book B17, p. 271; Deed Book J17, p. 38; Deed Book L15, pp. 191, 192. Charleston County Clerk of Court, Charleston, S.C.
- Reynolds, Emily Bellinger and Faunt, Joan Reynolds, ed. Bibliographical Directory of the Senate of the State of South Carolina, 1776-1964. Columbia, S.C.: South Carolina Archives Department, 1964, pp. 148, 191.
- Ross, Charles. Mayor of Lincolville, S.C. Interview, April, 1978.
- "South Carolina: The Men Who Hold Office in the State." The New York Times, 15 June 1874, p. 1.
- Williamson, Joel. After Slavery: The Negro in South Carolina During Reconstruction, 1861-1877. Chapel Hill: The University of North Carolina Press, 1967, pp. 190, 206, 207.

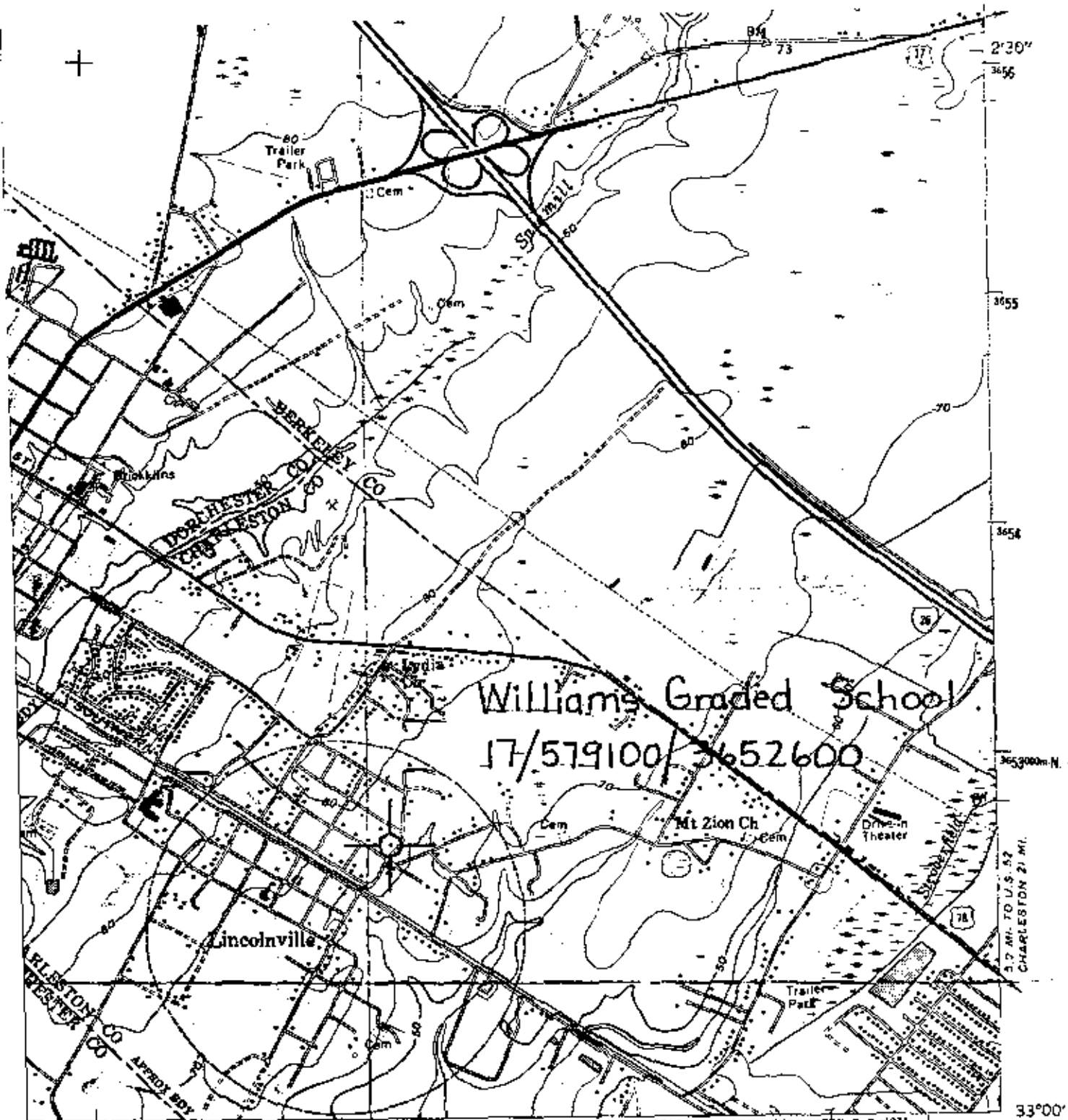

INTERIOR GEOLOGICAL SURVEY, WASHINGTON, D. C. - 1974
581000m E

ROAD CLASSIFICATION

- Heavy-duty ————
- Medium-duty ————
- Light-duty ————
- Unimproved dirt - - - -
- U.S. Route (rectangle symbol)
- State Route (circle symbol)
- Interstate Route (oval symbol)



QUADRANGLE LOCATION

SUMMERVILLE, S. C.

N3300-W8007.517.5

1958
PHOTOREVISED 1971
AMS 4850 II SW—SERIES V848

LADSON
SCALE 1:50,000

USCCBS
MUSSELL HOUSE
705848772
STOCK
1972 10 31 33

Revisions shown in purple compiled from aerial photographs taken 1971. This information not field checked

Purple tint indicates extension of urban areas

Summerville Quadrangle

Tax Map Number
C 385-1-0
Charleston County, S.C.
1" = 100'

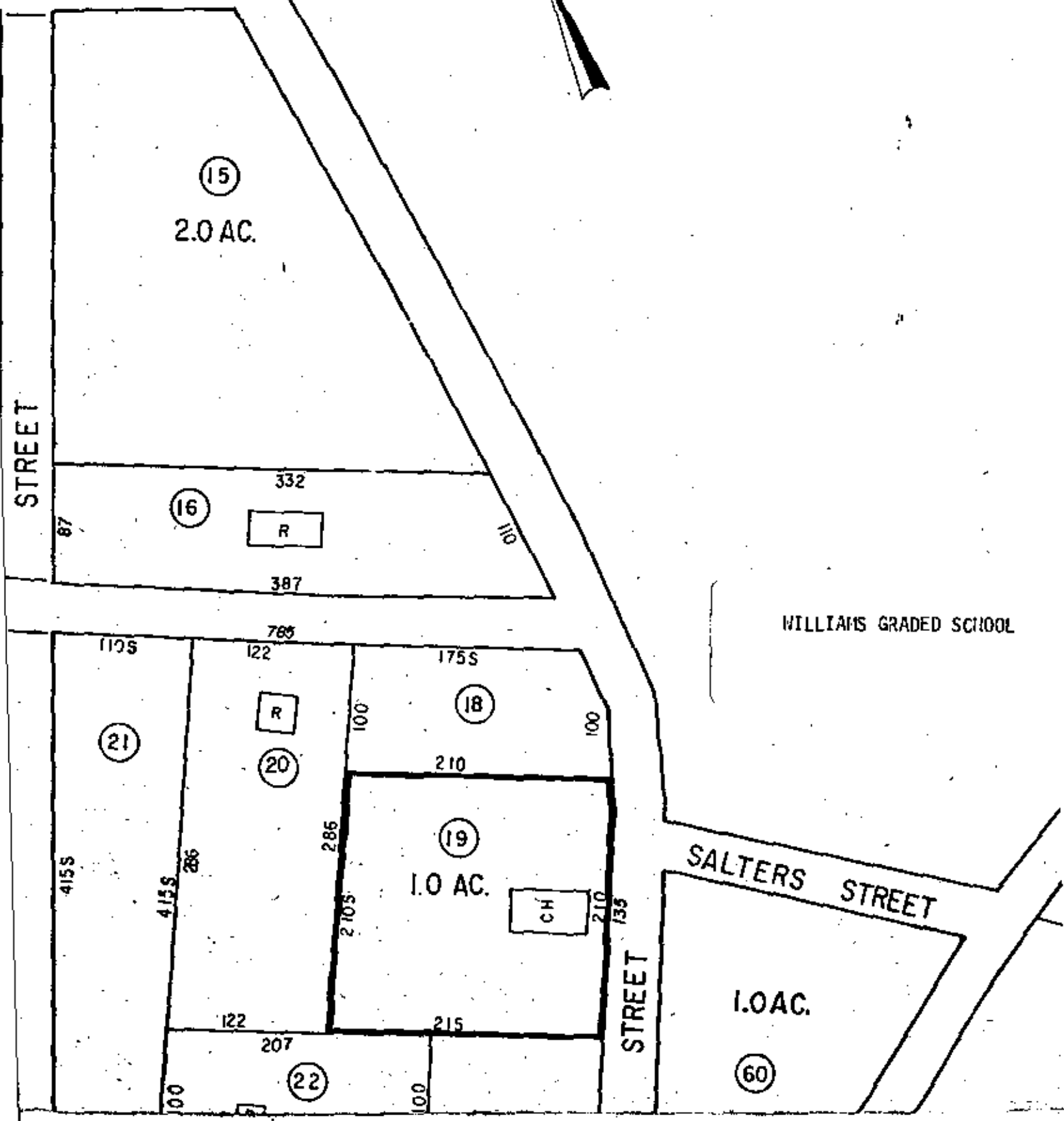
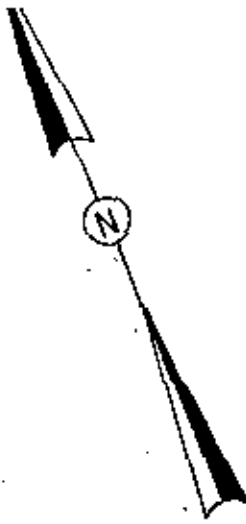

(15)
2.0 AC.

(16)
R

(18)
1.0 AC.
CH

(20)
R

(21)

(22)

1.0 AC.

(60)

WILLIAMS GRADED SCHOOL

SALTERS STREET

STREET

STREET